

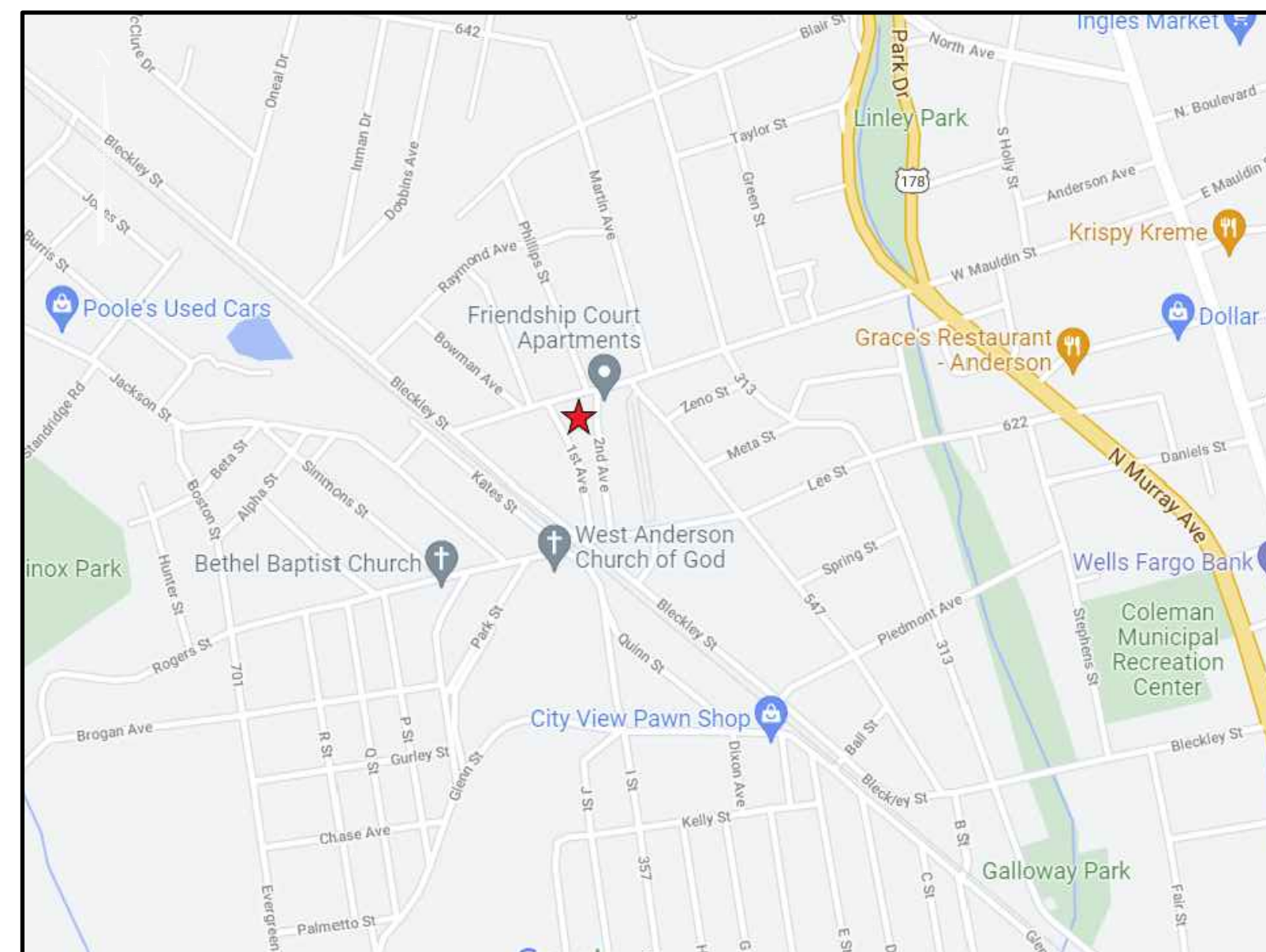

BASKETBALL COURT REHABILITATION

ST. FRANCIS PARK - 819 W. MAULDIN STREET



VICINITY MAP
NOT TO SCALE
SOURCE: GOOGLE MAPS

PROJECT CONTACTS

<p>CITY SANITARY SEWER: DAVID GLESON – SEWER LINE SUPERINTENDENT OFFICE: (864)–231–2250 CELL: (864)–328–7037 EMAIL: dgleson@cityofandersonsc.com</p>	<p>CITY ENGINEER: LACRECIA BILBREY OFFICE: (864)–231–2246 CELL: (864)–221–2642 EMAIL: lbilbrey@cityofandersonsc.com</p>
<p>WATER DEPARTMENT: JOSH HANEY OFFICE: (864)–231–5230 CELL: (864)–437–4269 EMAIL: jhaney@cityofandersonsc.com</p>	<p>CITY STORMWATER MANAGER: ADAM CROMER OFFICE: (864)–231–2246 CELL: (864) 245–6288 EMAIL: acromer@cityofandersonsc.com</p>
<p>DUKE POWER: AL WRIGHT – ENGINEER OFFICE: (864)–260–6043 CELL: (864)–617–5437 EMAIL: awright@duke-energy.com</p>	<p>PIEDMONT NATURAL GAS: TONY MACKEY – UTILITY FIELD REP. OFFICE: (864)–716–4585 CELL: (864)–844–0085 EMAIL: tony.mackey@pedmontng.com</p>
<p>STAN COMPTON – ENGINEER OFFICE: (864)–260–6043 CELL: (864)–617–4353 EMAIL: hscampton@duke-energy.com</p>	
<p>JAMES COLLIER – Sr. DISTRIBUTION ENGINEER SPC OFFICE: (864)–260–6043 CELL: (864)–934–2298 EMAIL: james.collier@duke-energy.com</p>	

DRAWING INDEX

- 1 COVER SHEET
- 2 SITE PLAN
- 3 CONTROL JOINT PLAN & DETAILS

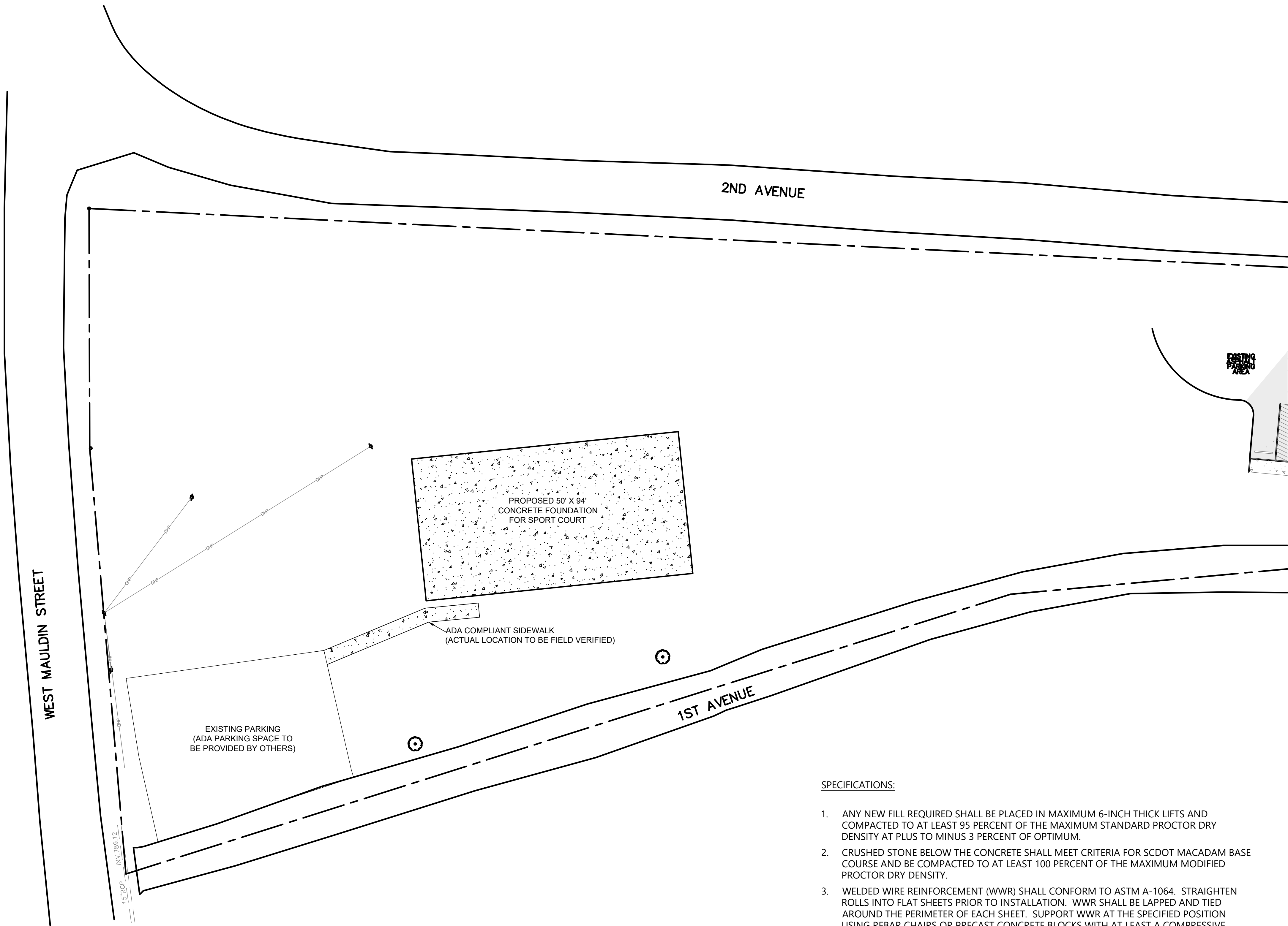

SPECIFICATIONS:

1. ANY NEW FILL REQUIRED SHALL BE PLACED IN MAXIMUM 6-INCH THICK LIFTS AND COMPACTED TO AT LEAST 95 PERCENT OF THE MAXIMUM STANDARD PROCTOR DRY DENSITY AT PLUS TO MINUS 3 PERCENT OF OPTIMUM.
2. CRUSHED STONE BELOW THE CONCRETE SHALL MEET CRITERIA FOR SCDOT MACADAM BASE COURSE AND BE COMPACTED TO AT LEAST 100 PERCENT OF THE MAXIMUM MODIFIED PROCTOR DRY DENSITY.
3. WELDED WIRE REINFORCEMENT (WWR) SHALL CONFORM TO ASTM A-1064. STRAIGHTEN ROLLS INTO FLAT SHEETS PRIOR TO INSTALLATION. WWR SHALL BE LAPPED AND TIED AROUND THE PERIMETER OF EACH SHEET. SUPPORT WWR AT THE SPECIFIED POSITION USING REBAR CHAIRS OR PRECAST CONCRETE BLOCKS WITH AT LEAST A COMPRESSIVE STRENGTH OF 4000 PSI.
4. CONCRETE SHALL BE AIR-ENTRAINED (4% TO 6%) WITH A COMPRESSIVE STRENGTH OF 4000 PSI AT 28 DAYS AND CONTAIN SYNTHETIC REINFORCING FIBER.
5. CONCRETE MIX SHALL BE SUBMITTED TO THE ENGINEER FOR APPROVAL AT LEAST 7 DAYS PRIOR TO PLACEMENT OF CONCRETE.
6. CONCRETE SHALL BE PLACED IN ONE CONTINUOUS POUR WITHOUT THE USE OF CONSTRUCTION JOINTS.
7. THE CONCRETE SURFACE SHALL BE FINISHED WITH TROWELS AND BE COMPLETED WITH A LIGHT BROOM FINISH. DO NOT APPLY CONCRETE WATER SEALER.
8. ROUND OR BEVEL THE EDGES OF THE CONCRETE COURTS.
9. SAW CUT CONTROL/CONTRACTION JOINTS AS SOON AS CONCRETE WILL WITHSTAND SAWING BUT NO MORE THAN 12 HOURS FOLLOWING CONCRETE PLACEMENT.
10. INSTALL FLEXIBLE CONTROL JOINT FILLER (SILKAFLEX OR APPROVED EQUAL) IN ALL CONTROL JOINTS PER MANUFACTURER'S RECOMMENDATION.

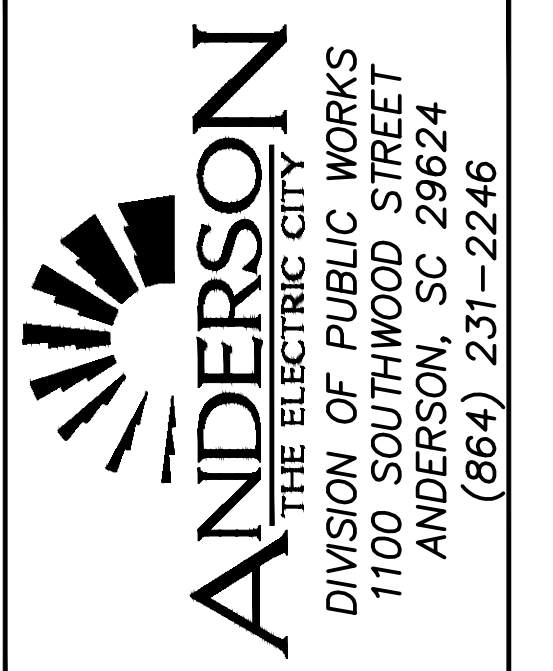

ST. FRANCIS PARK BASKETBALL
COURT REHABILITATION
CITY OF ANDERSON SOUTH CAROLINA
SITE PLAN

DRAWN BY: LCB
 CHECKED BY: LCB
 DATE: 9/13/2021
 SCALE: 1"=20'
 JOB #: 124579
 REVISIONS:

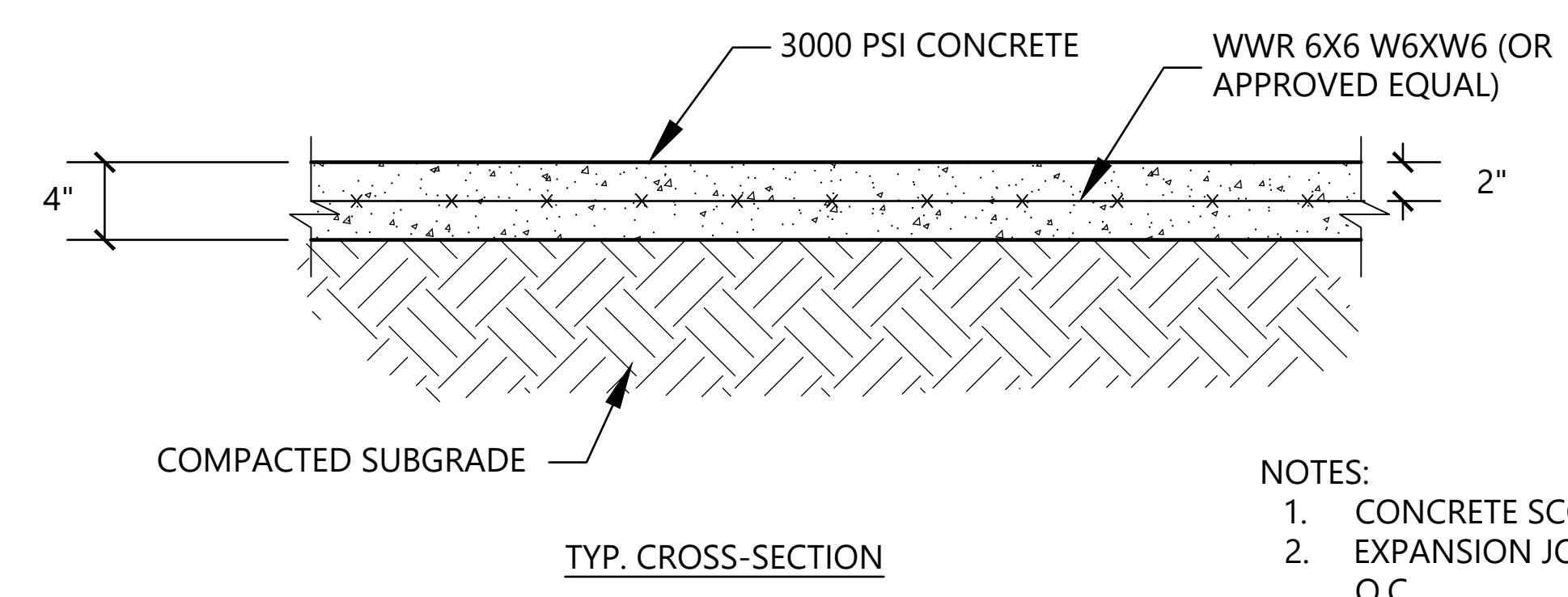
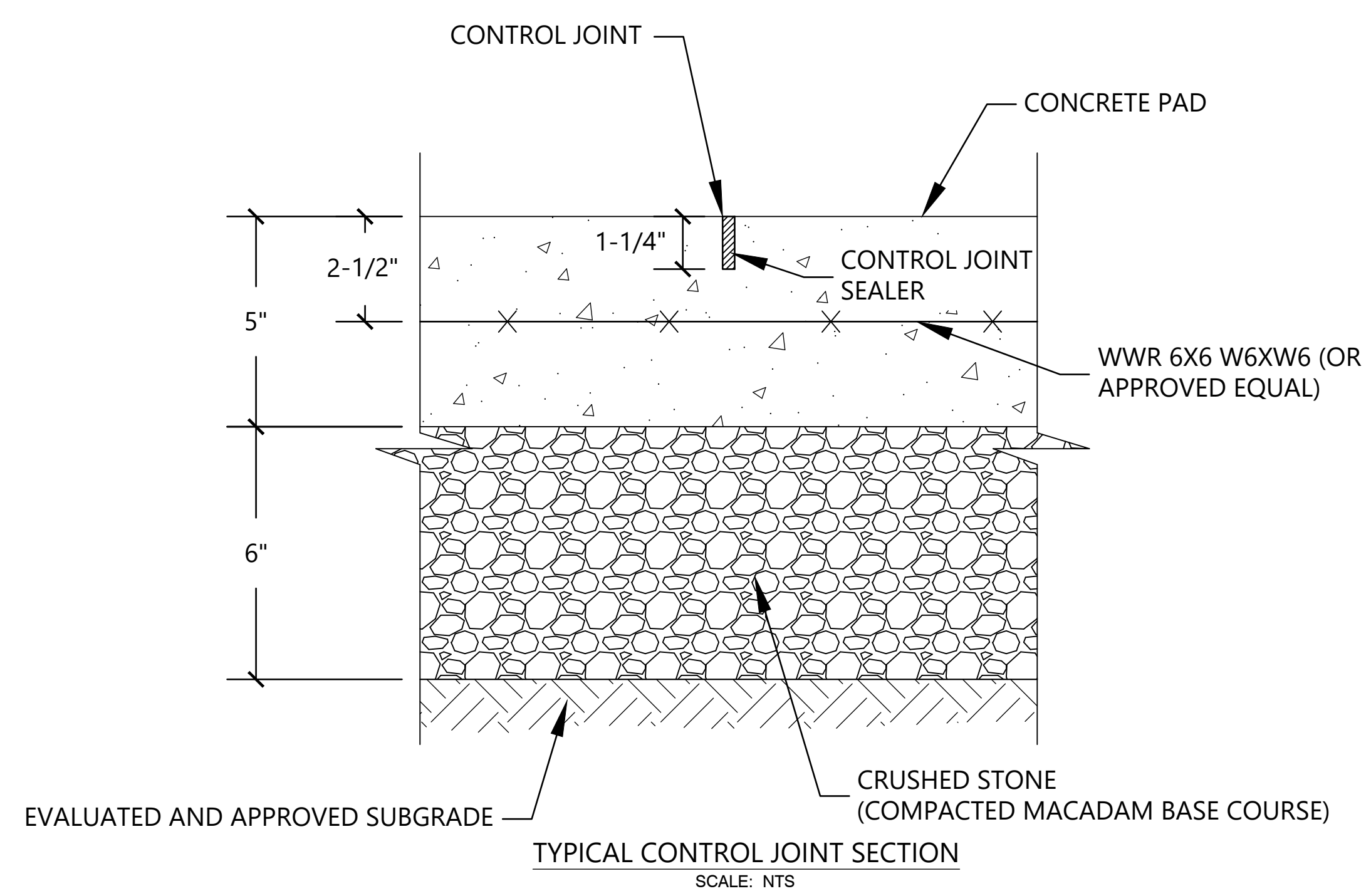
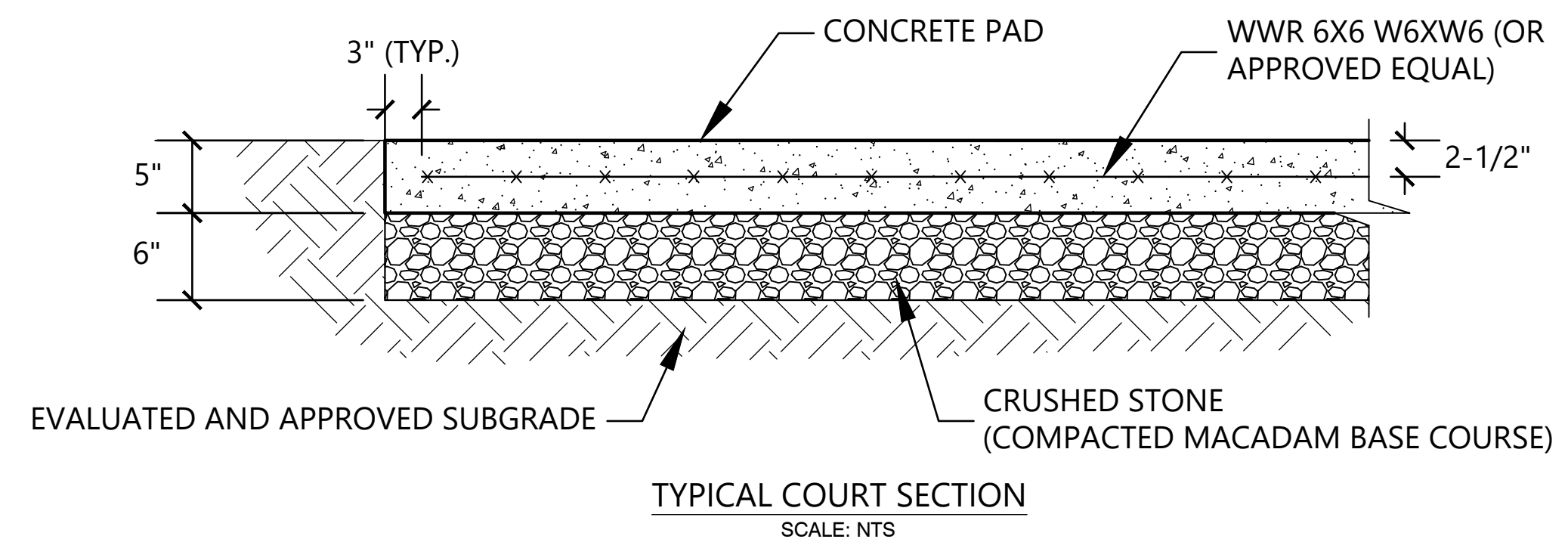
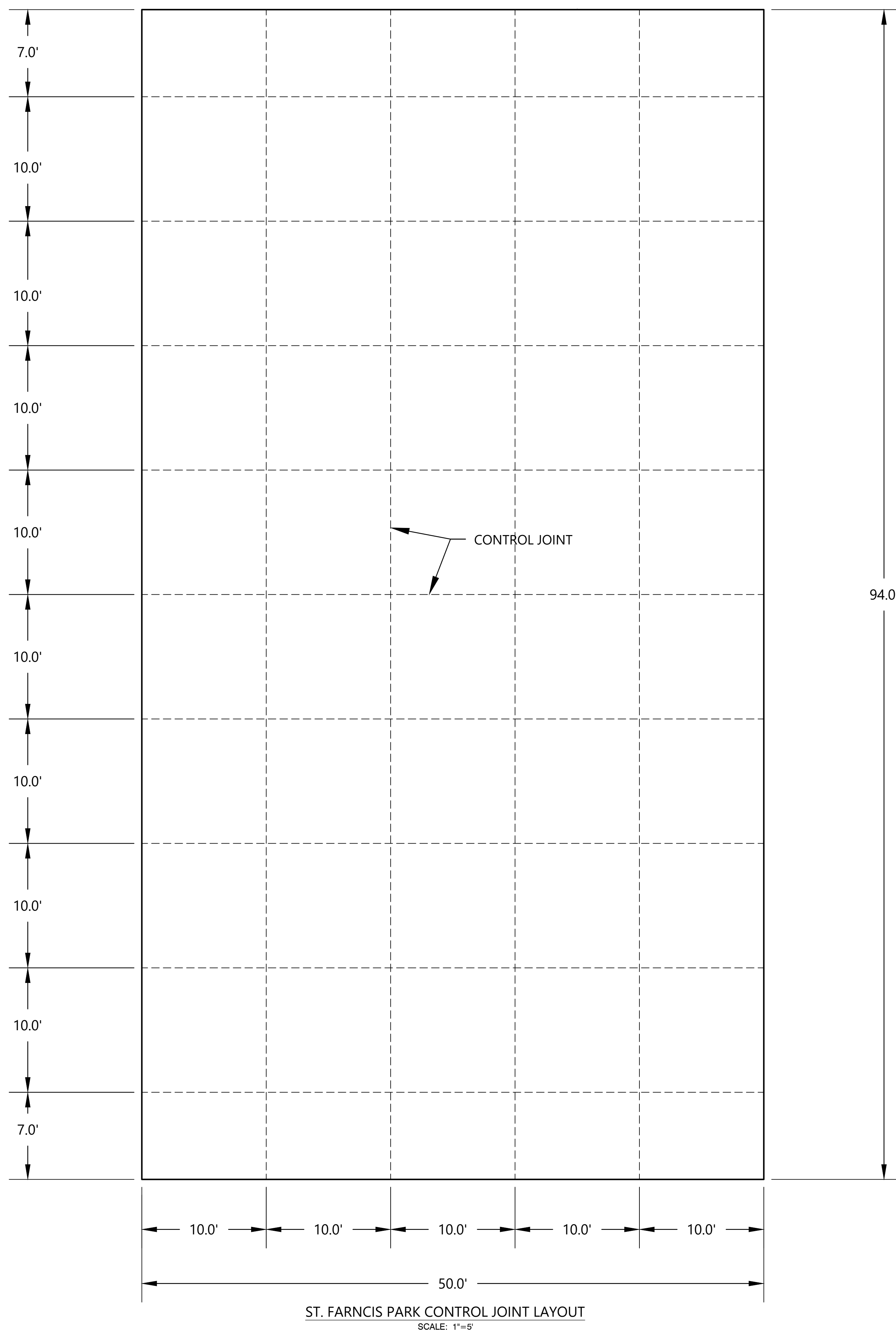

- NOTES:
1. CONCRETE SCORING SHALL BE 5' O.C.
 2. EXPANSION JOINTS SHALL BE PROVIDED 30' O.C.
 3. SIDEWALK CROSS-SLOPE SHALL NOT EXCEED 2%, AND SHALL MEET ADA DESIGN STANDARDS.
 4. ALL JOINTS AND SCORING SHALL BE SAWN WITH 1/2" RADIUS ROUTER BLADE TO SIMULATE TOOLED JOINT.
 5. SIDEWALK SHALL BE BROOM FINISHED PERPENDICULAR TO WALK DIRECTION.

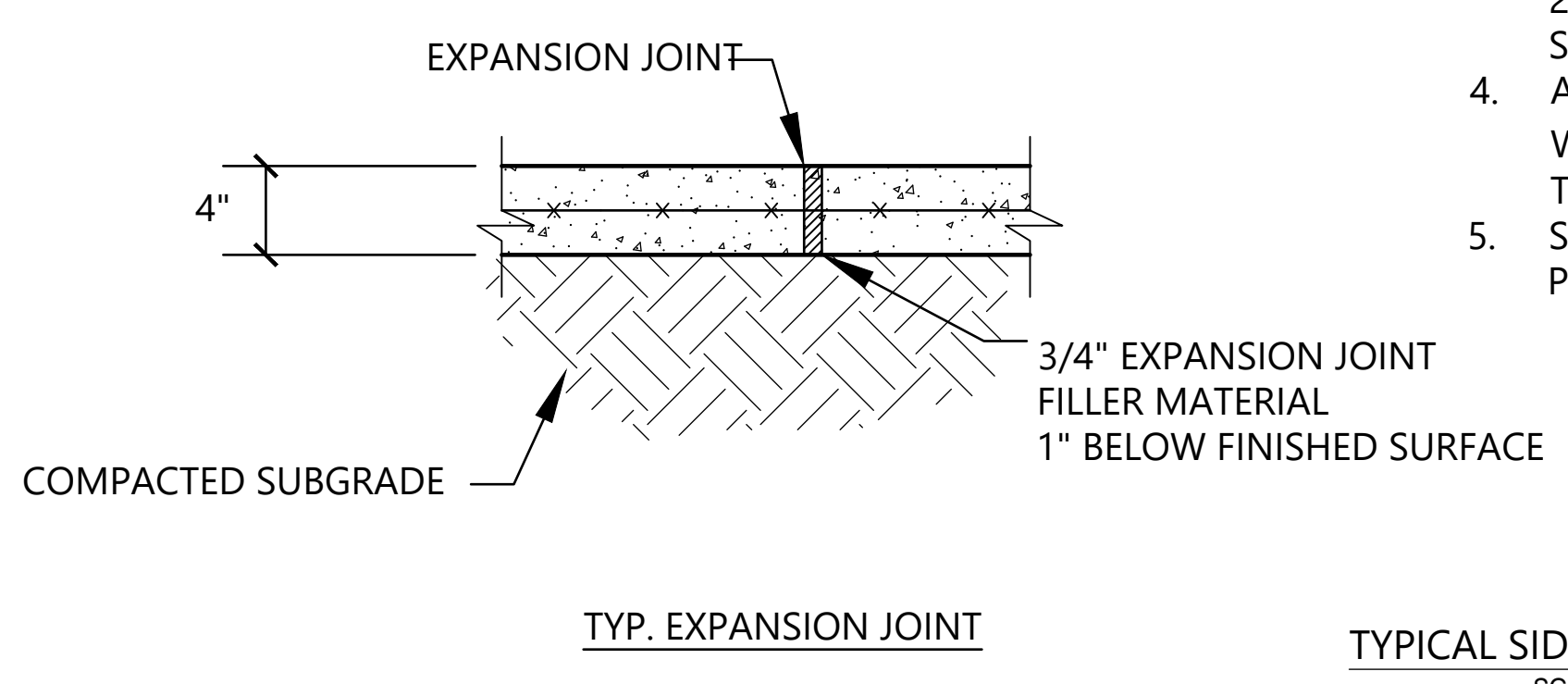

TYPICAL SIDEWALK SECTION
SCALE: NTS

DRAWN BY: LCB
CHECKED BY: LCB
DATE: 9/13/2021
SCALE: 1"=5'
JOB #: 124579
REVISIONS: